

| ITEM NO. | PART NUMBER | DESCRIPTION | QTY. |
|----------|-------------|-------------------------------------|------|
| 1 | 171604 | 400L VERTICAL BAFFLED SLIMLINE TANK | 1 |
| 2 | 135322 | Ø255 SCREW LID & RIM | 1 |

| DESIGN DATA | |
|---|-----------------------------|
| DESIGN PRESSURE: ATMOSPHERIC | MAXIMUM CAPACITY (LTRS): |
| DESIGN TEMPERATURE: 40°C | WORKING CAPACITY (LTRS): |
| WORKING PRESSURE: ATMOSPHERIC | APPROX. WEIGHT FULL (KGS): |
| WORKING TEMPERATURE: 40°C | APPROX. WEIGHT EMPTY (KGS): |
| MOULDED LIFTING LUGS: 4 - 0°, 90°, 180° & 270° | |
| METHOD OF SUPPORT: FIRM, FLAT, FULLY SUPPORTING BASE OF CONCRETE OR OTHER SUITABLE MATERIAL | |

| MATERIAL DATA |
|---|
| MATERIALS OF CONSTRUCTION: |
| MATRIX REVOLVE N-307. REVOLVE IS A HIGH DENSITY (0.939 g/cm3), LOW MELT (3.5 g/ 10 min) HEXENE POLYETHYLENE GRADE FOR ROTOMOULDING. THE GRADE IS FULLY PROTECTED AGAINST THERMAL AND LIGHT DEGRADATION: N-307 IS UV10 STABILISED. |

| INSPECTION AND TESTING |
|---|
| WORKS TEST: ALL TANKS ARE THICKNESS TESTED BY ULTRASOUND AFTER DEMOULD. IN ADDITION, AIR SUPPORTED LEAK TEST ARE CARRIED OUT ON FLANGE LINES. |

| NOTE SECTION |
|--------------|
| |

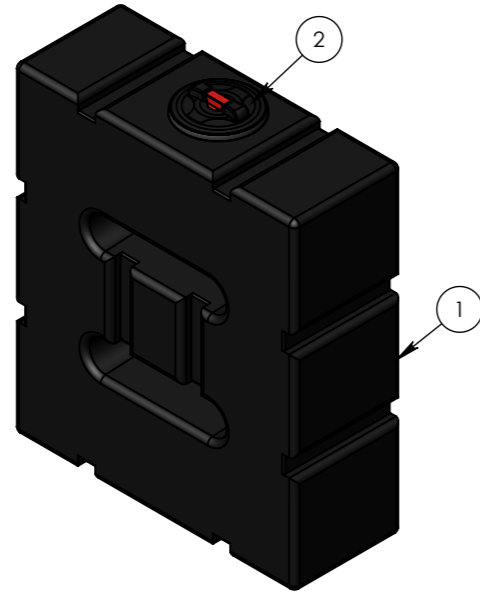

LEFT ISO VIEW
SCALE 1 : 20

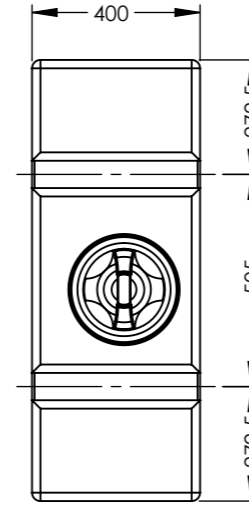

PLAN VIEW

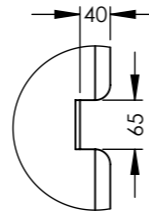

DETAIL A
SCALE 1 : 10

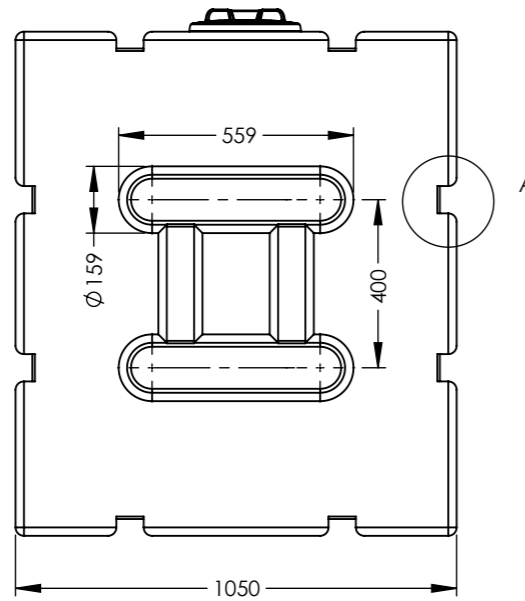

LEFT VIEW

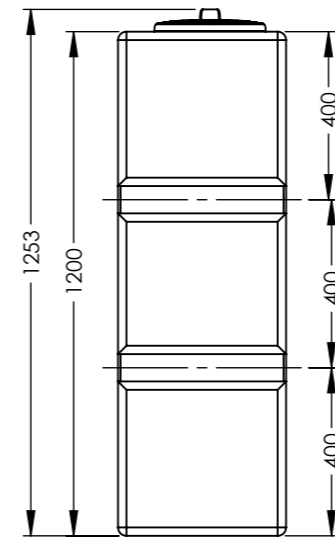

FRONT VIEW

| | NAME | SIGNATURE | DATE |
|---------|------|-----------|------------|
| DRAWN | LC | L.Crane | 03/03/2023 |
| CHECKED | | | |

| | |
|---|--------------------------|
| UNLESS OTHERWISE SPECIFIED: DIMENSIONS ARE IN MILLIMETERS SURFACE FINISH: MDPE TOLERANCES: ±3% | 3RD ANGLE PROJECTION |
|---|--------------------------|

| | |
|----------------------|-------------|
| DO NOT SCALE DRAWING | REVISION: - |
|----------------------|-------------|



| | |
|------------|-------------------------------------|
| DWG TITLE: | 400L VERTICAL BAFFLED SLIMLINE TANK |
|------------|-------------------------------------|

| | |
|-----------------------|----|
| DWG NO: 171604-400-BV | A3 |
|-----------------------|----|

| | |
|-------------|--------------|
| SCALE: 1:18 | SHEET 1 OF 2 |
|-------------|--------------|